



Picture showing dome with handles only

MODEL 6509 INTEGRATED ELECTRONIC CONTROL HEAD

The compact design of this control head allows it to be fitted into small spaces. The upper portion is of a water tight construction and can, therefore, be installed anywhere on board ship. It is made entirely in bronze and stainless steel and is well adapted to the harsh marine environment.

The 6509 control head is also available in a single engine configuration. Non-illuminated side decals can be attached to the control head for fixed propulsion applications.

The membrane key pad has four standard switches and provides:

- Station Select
- Station Lock
- Overriding Throttle
- Engine Synchronization

Trolling valve options are also available in place of either one of the above four switches. The membrane has back lit lenses that indicate which function is working.

MODEL 6509

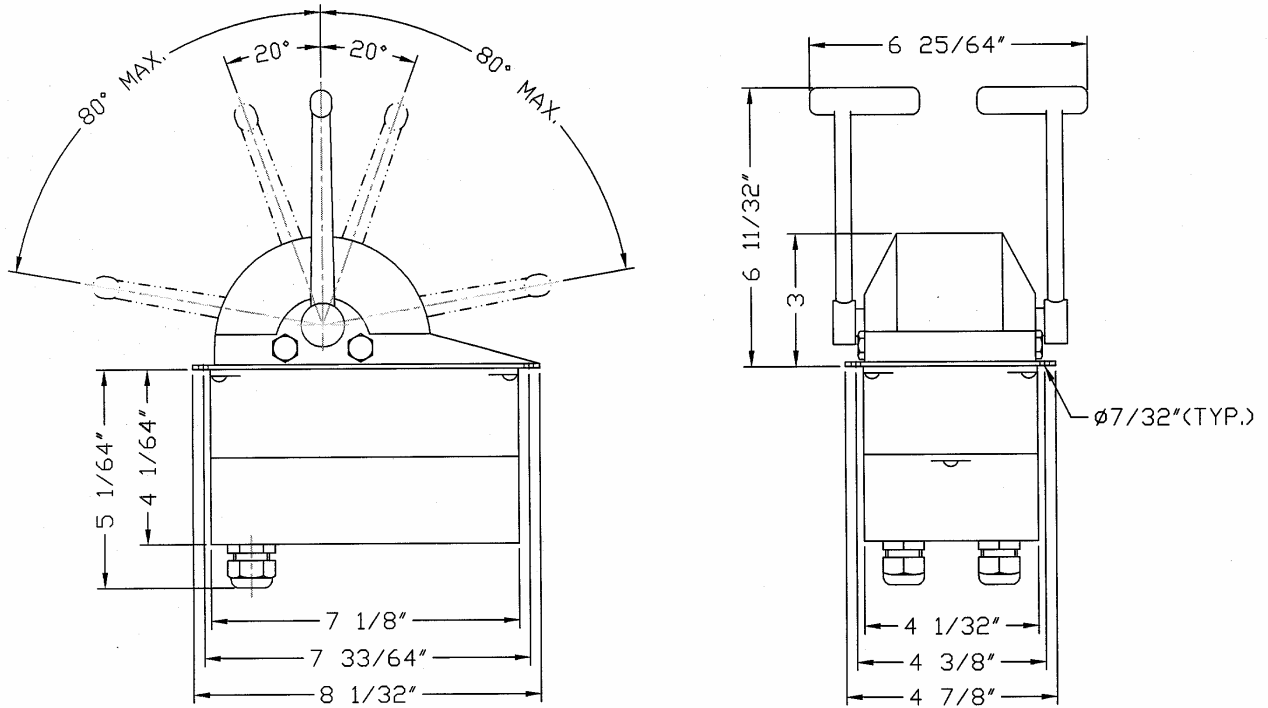

All Dimensions in inches (mm)