

CUT AS SHOWN ABOVE,  
NOT AS SHOWN BELOW

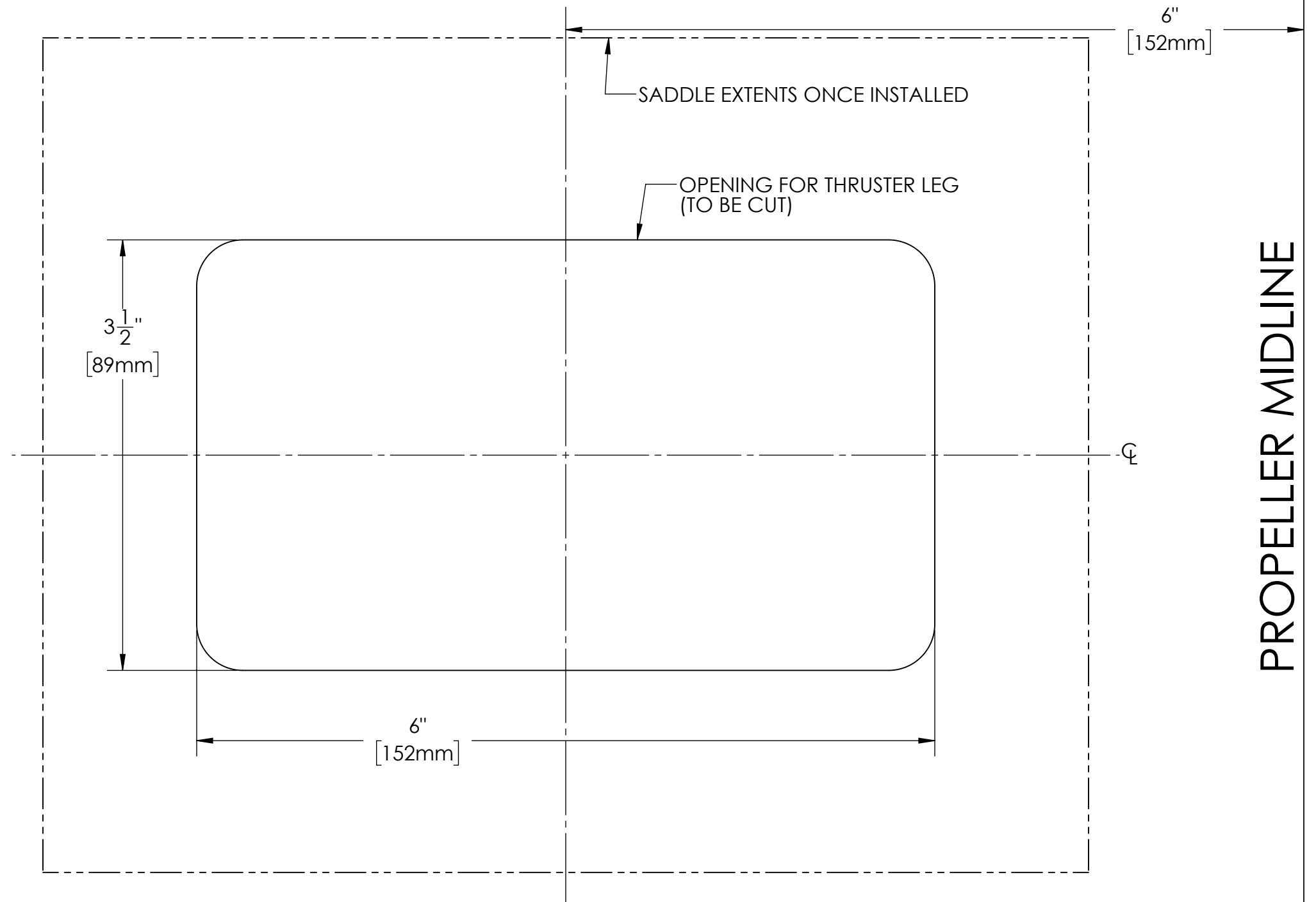
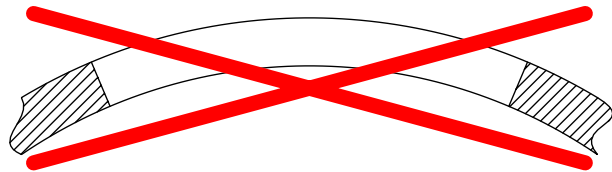

**NOTES:**

1. PRINT DOCUMENT AT 1:1 SCALE.
2. MEASURE PRINTED DOCUMENT TO CONFIRM THAT PRINT MATCHES DIMENSIONS. IF PRINT DEVIATES, ADJUST SCALE AND REPRINT.
3. WRAP TEMPLATE AROUND THE THRUSTER TUBE WHILE ENSURING C IS PARALLEL TO THE TUBE AXIS.
4. LOCATE TEMPLATE AXIALLY SO THAT PROPELLER MIDLINE IS AT THE DESIRED LOCATION.
5. CUT THE OPENING FOR THE THRUSTER LEG THROUGH THE TUBE AS SHOWN IN THE FIGURE ON LEFT OF THIS DOCUMENT.

THE INFORMATION CONTAINED IN THIS DRAWING IS  
THE SOLE PROPERTY OF KOBELT MANUFACTURING.  
ANY REPRODUCTION IN PART OR AS A WHOLE  
WITHOUT THE WRITTEN PERMISSION OF KOBELT  
MANUFACTURING IS PROHIBITED.

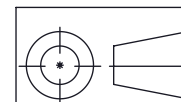

<b>KOBELT</b>		<b>KOBELT MANUFACTURING CO. LTD.</b>		8238 129 St. SURREY, B.C. CANADA V3W 0A6 TEL. (604) 572-3935 www.kobelt.com	
		NAME	DATE	TITLE:	
DIMENSIONS IN INCHES UNLESS OTHERWISE SPECIFIED: ANGULAR X° +/-0.5° LINEAR X.X +/-0.1 X.XX +/-0.01 X.XXX +/-0.005 FRACTION +/- 1/64		DWN: BA	21/09/20	<b>CUT OUT TEMPLATE - TUNNEL; KP10 THRUSTER</b>	
ALL MACHINED SURFACES $\nabla_{125}$		APR:			
MATERIAL:		WEIGHT:		SIZE <b>B</b>	DRAWING No: cutKP10X
				SHEET: 1 of 1	SCALE: 1:1
				REV <b>A</b>	